

UNITS 1-5
FIRST FLOOR PLAN

179

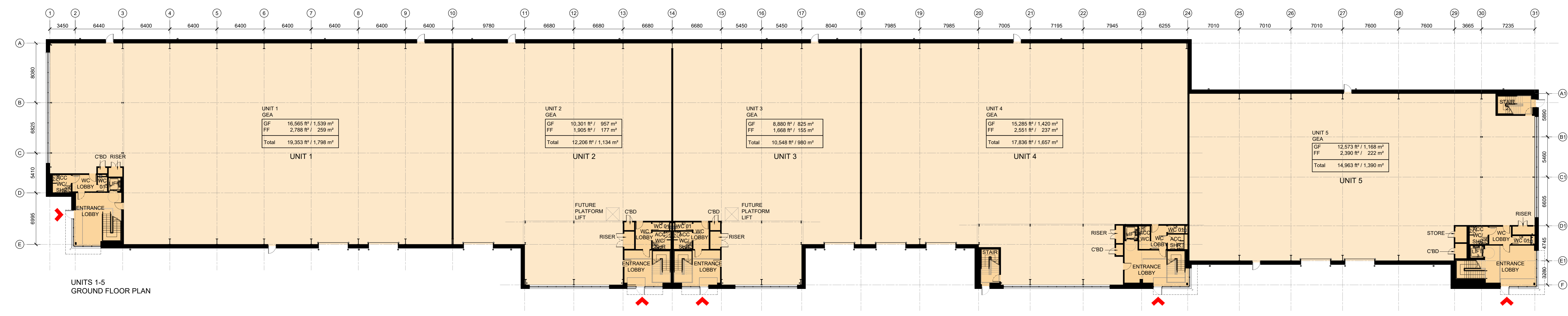

UNITS 1-5
GROUND FLOOR PLAN

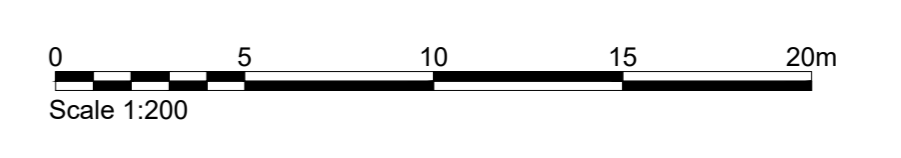

Client:
HE2 READING 1 GP LTD (LONDON)



Project:
HEADLEY ROAD EAST
WOODLEY

12 Warren Yard,
Warren Park,
Milton Keynes,
MK12 2DW
01889 355248
info@prcgroup.com
www.prcgroup.com

Drawing Title:
UNITS 1-5
PROPOSED FLOOR PLANS

Scale @ A2: 1:200
 Checked by: JR
 Date: SEPT 21
 Job No: 11359
 Stage: PL 110
 Rev: A

Architecture
 Planning
 Master Planning
 Urban Design
 Interiors
 Landscape

Issue Status:
 Construction Preliminary
 Information Approval
 Tender
 Offices
 Working London
 Milton Keynes
 Warsaw

This page is intentionally left blank